

GLOBAL AIR SUPPLIES UK

13 AMP ENVIRO CONTROLLER V2

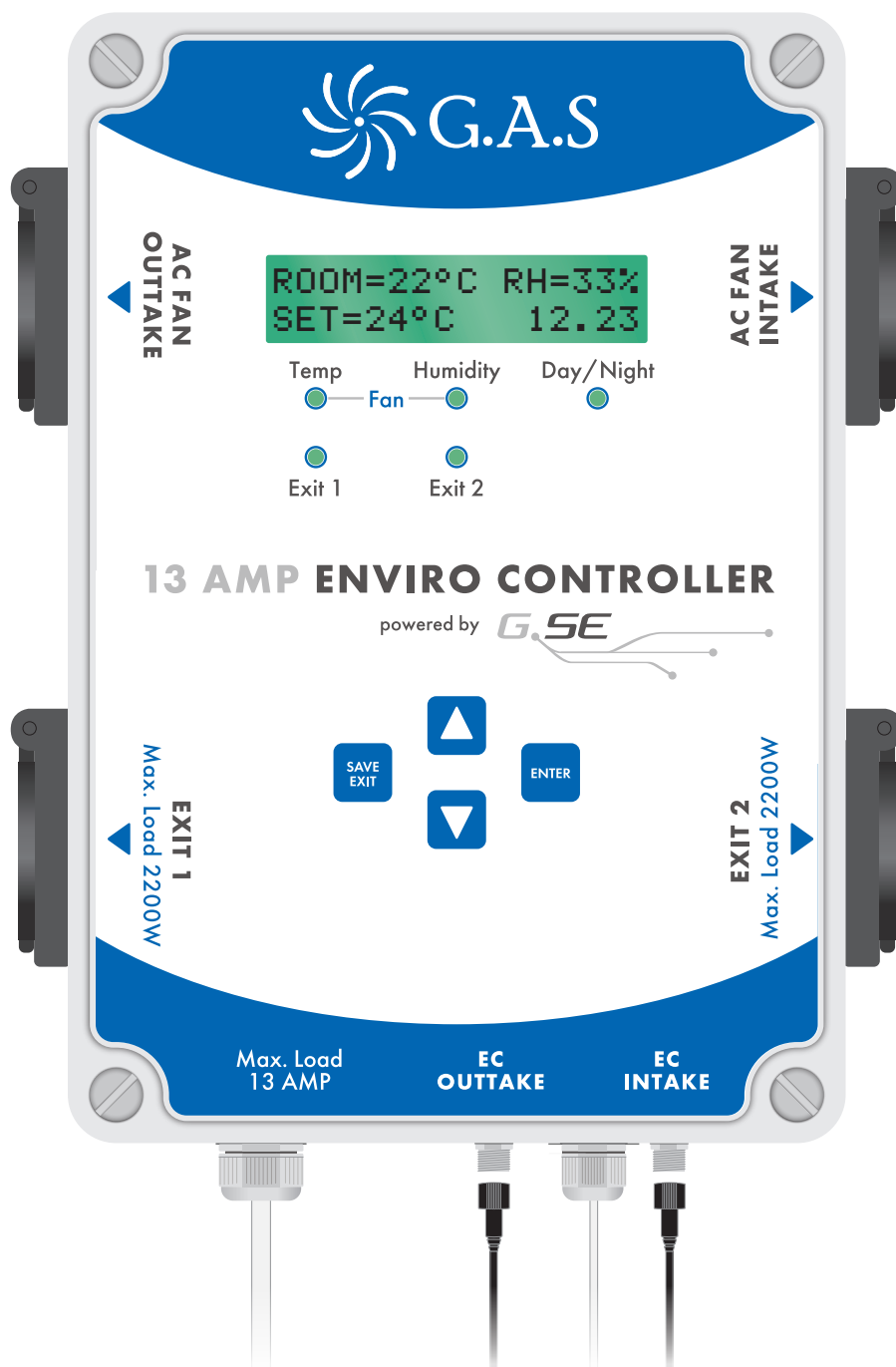

CONTENTS

IN THE BOX	2
TECHNICAL SPECIFICATION	2
MOUNTING YOUR UNIT	2
SENSOR POSITIONING	3
CONNECTING YOUR FANS	3

USING YOUR 13AMP ENVIRO CONTROLLER V2 4-14

– LED'S	5
– CONTROL KEYS	5
– HOME SCREEN	5
– GENERAL SETTINGS	6
– FAN SETTINGS MENU	10
– EXIT 1 AND 2 SETTINGS MENU	13

IN THE BOX

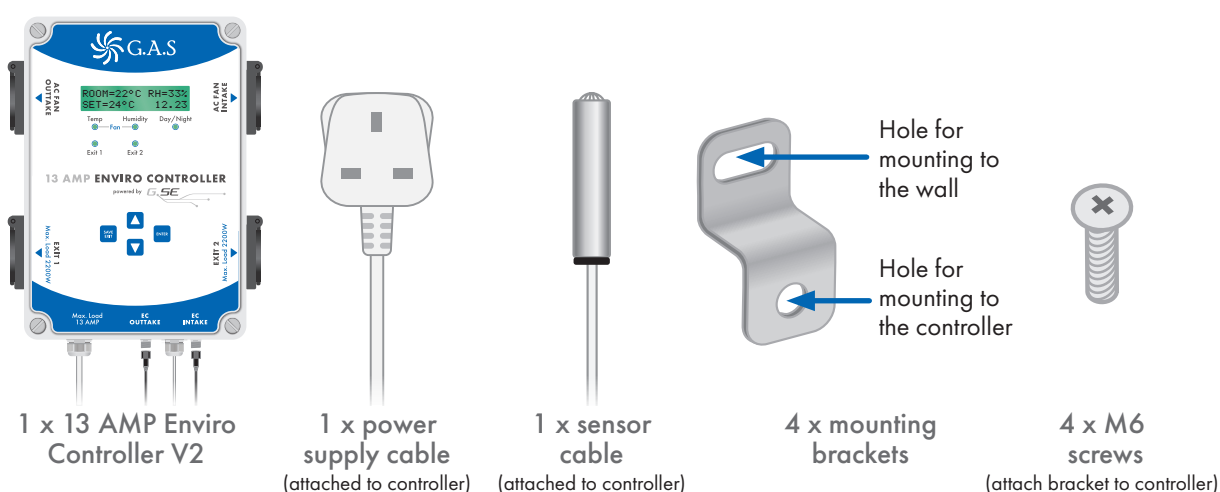

TECHNICAL SPECIFICATION

- Operating Voltage 230V / 50 Hz
- Max Amp 13
- Loading of the individual outputs
 - Intake Fan Max: 10A 2300W
 - Outtake Fan Max: 10A 2300W
 - Exit 1 Max: 10A 2300W
 - Exit 2 Max: 10A 2300W

The total load on all the sockets MUST NOT be more than 2900W!

MOUNTING YOUR UNIT

- **Make sure the unit is unplugged.**
- Screw the mounting brackets to the unit and screw the unit to the wall.
- **PLEASE NOTE: Mount the unit on a non-flammable surface. Make sure the unit is in a well ventilated area and away from water and high humidity.**
- The unit is sealed to IP44 however to prevent any water ingress it is recommended that the unit is mounted outside of the grow room.

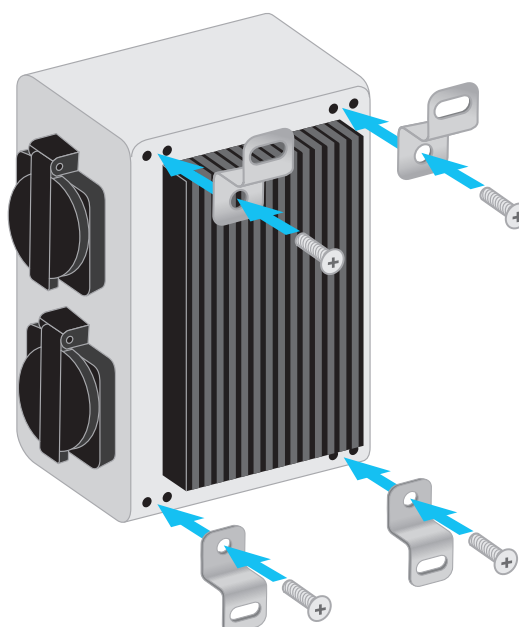

SENSOR POSITIONING

- The best position for the sensor is the middle of the grow room, just above the canopy.

PLEASE NOTE: We advise you have good air circulation in your grow room, this will prevent hot spots or high humidity zones. The sensor will be more accurate if the air is moving inside the grow room, therefore making the controller more accurate.



CAUTION

The sensor is a sensitive device.
Do not drop or hit the sensor.
Damage to the sensor may not be covered by warranty.
KEEP AWAY from water and aerosols.

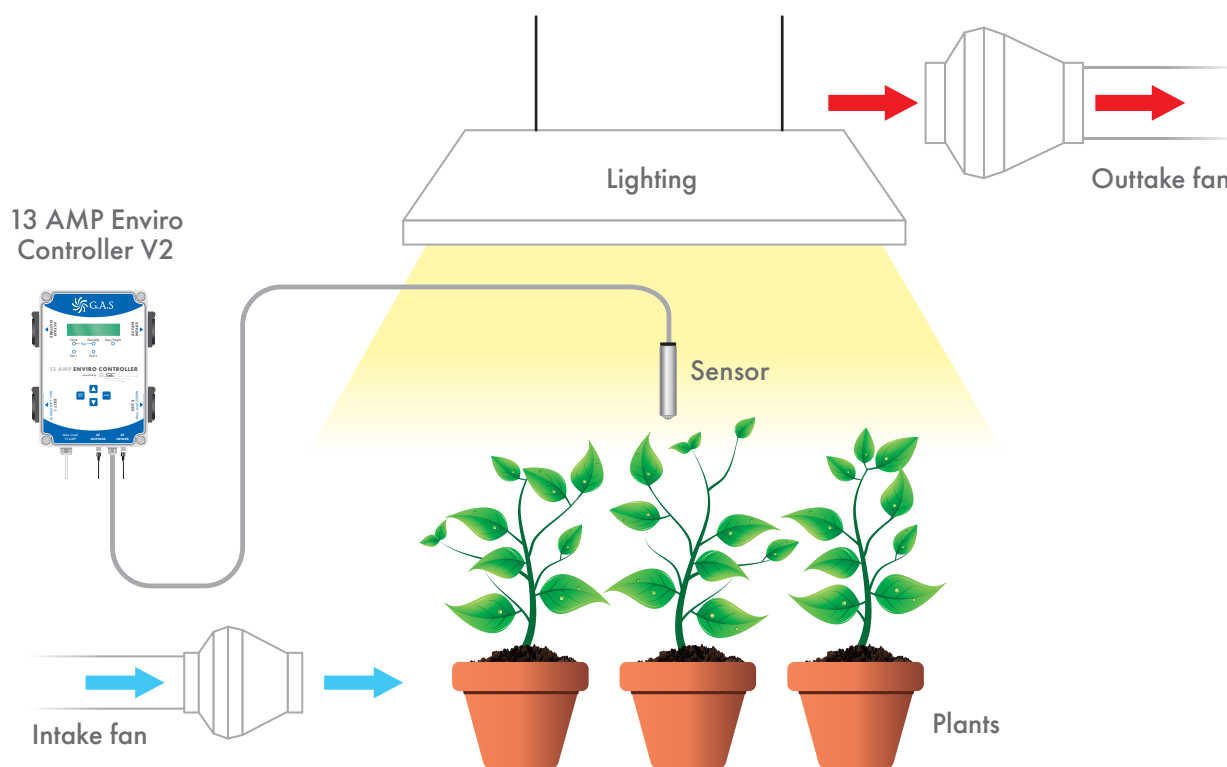

CONNECTING YOUR FANS

- The 13 AMP Enviro Controller V2 can be used with AC or EC Fans.
- To connect AC fans, simply plug the fan into the top two plug sockets on the side of the controller.
AC FAN OUTTAKE connects to your outtake and your intake connects to **AC FAN INTAKE**.
- To connect your EC fans, connect the EC signal cable to the controller and to the signal cable on your fans. **EC INTAKE** connects to your intake fan and **EC OUTTAKE** to your outtake fan.

PLEASE NOTE: Never connect the mains power lead from EC fans to the AC fan plug sockets. Serious damage will occur to your EC fans.



CAUTION

ALL FANS will turn on when the controller is plugged in/switched on.

USING YOUR 13 AMP ENVIRO CONTROLLER V2

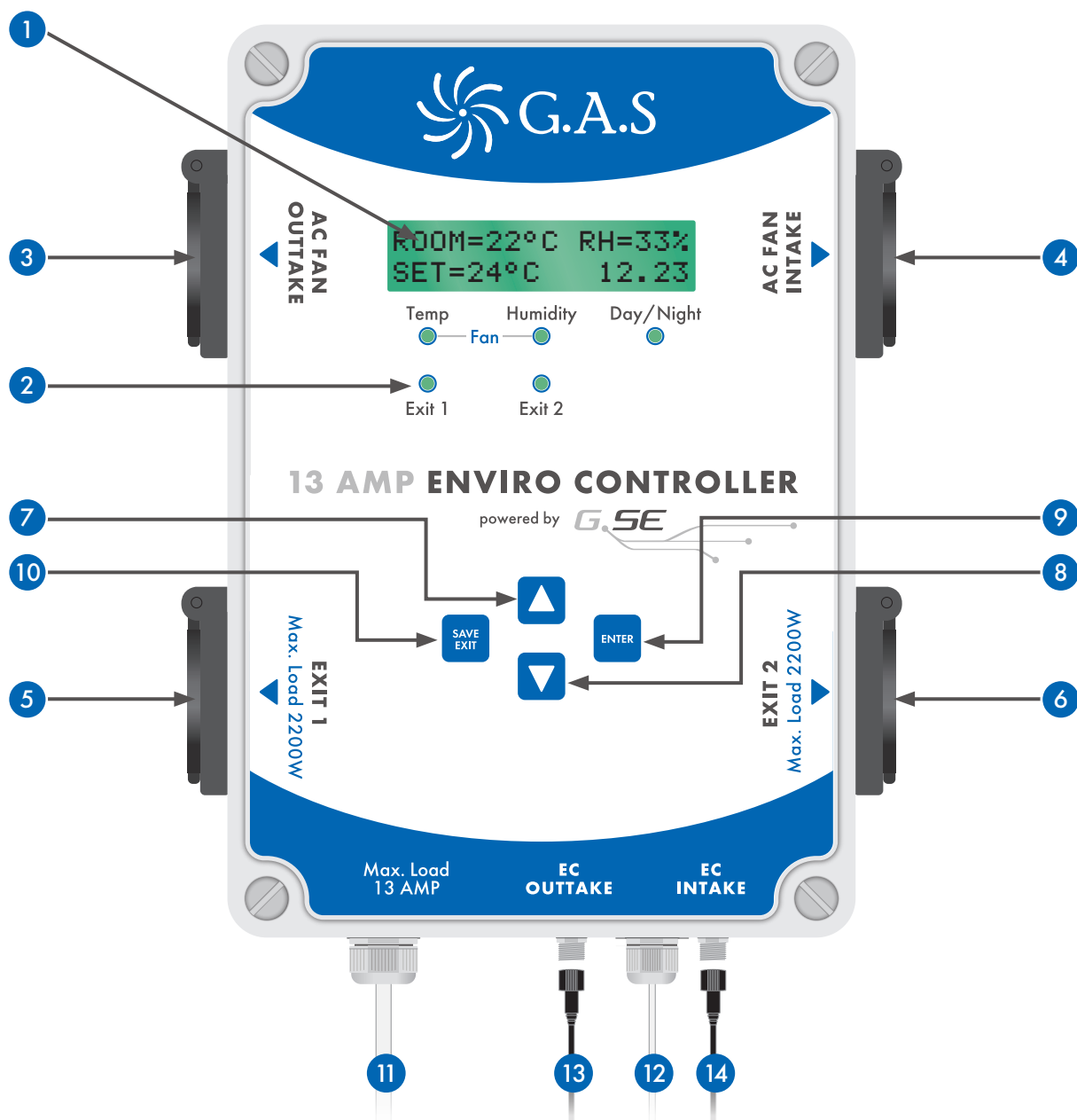

KEY

- | | |
|-----------------------------------|--|
| 1 LCD information display | 8 Menu down key |
| 2 LED indication lights | 9 Menu enter key |
| 3 AC fan outtake plug socket | 10 Menu save and exit key |
| 4 AC fan intake plug socket | 11 Power supply |
| 5 Programmable Exit 1 plug socket | 12 Sensor cable for the humidity, light and temperature sensor |
| 6 Programmable Exit 2 plug socket | 13 EC outtake signal cable (available separately) |
| 7 Menu up key | 14 EC intake signal cable (available separately) |

LED's

Five LED's on the front of the controller give you information about your grow room.

When the controller is turned on, all 5 LED's will briefly illuminate, then go off.

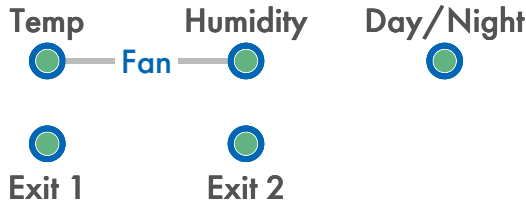

- Temp LED ON
Grow room is above set temperature.
- Humidity LED ON
Grow room is above set humidity.
- Day/Night LED
LED off indicates night time or lights are off.
Solid LED indicates day time or lights are on.
- Exit 1 LED ON
Exit 1 power supply is on.
- Exit 2 LED ON
Exit 2 power supply is on.

CONTROL KEYS

The controller is operated by four buttons.

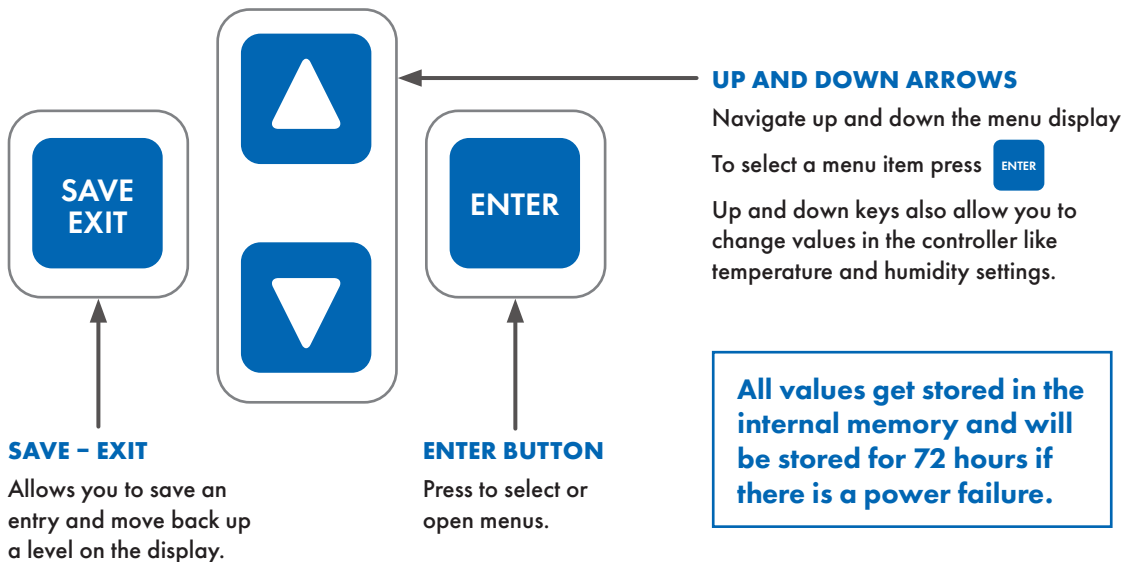

HOME SCREEN

When the controller is turned on, the 'Home Screen' is displayed. This shows your room temperature, relative humidity, fan setting and the time.

Press the **DOWN** arrow to view your current outtake and intake speeds.

Press **ENTER** to access all the sub menus.

Menus will **flash** to highlight selection.

If viewing a different menu, you can go back to the 'Home Screen' by either leaving the controller for 2 minutes, or by pressing the **SAVE EXIT** button repeatedly to move backwards through any sub menus.

MAIN MENU

Room=23°C	RH=60%
Set19°C	09:13

Press **DOWN**

Outtake	90%
Intake	70%

MAIN MENU

Room=23°C	RH=60%
Set19°C	09:13

Press **ENTER**

Set fan Speed
Set exit 1

Selected menus will flash

Set fan Speed

Press **ENTER** to select and access sub menus

USING YOUR 13 AMP ENVIRO CONTROLLER V2

GENERAL SETTINGS MENU

This menu allows you to change the main settings of the controller such as:

- Set time
- Set language
- Set photosensor
- Calibration
- Set display
- Reset to factory settings
- EC fan signal

TO ACCESS THE GENERAL SETTINGS MENU

From the Home Screen press **ENTER** to access the sub menus.

'Set fan Speed' and 'Set exit 1' will be displayed. Press the **DOWN** arrow to scroll down to 'General settings'.

With 'General settings' flashing, press **ENTER**.

ACCESSING GENERAL SETTINGS

Start from the Home Screen

```
Room=23°C RH=60%
Set19°C      09:13
```

Press **ENTER** to access the first sub menu

Press **DOWN** to scroll down to General settings

```
Set fan Speed
Set exit 1
Set exit 2
General settings
```

Press **ENTER** to access General settings

Press **DOWN** to scroll down the sub menus

```
Set time
Set language
Set Photosensor
Calibration
Set display
Res. factory set
EC fan signal
```

SETTING THE DATE/TIME

From the 'General settings' menu (see above), with 'Set time' flashing, press **ENTER** to access the set date & time settings.

Use the **UP** and **DOWN** arrows to change the Day.

Pressing **ENTER** will subsequently select the Month, Year and then the Time values.

Press **SAVE EXIT** to save your information, and to go back to the previous sub menu.

DATE/TIME SETTINGS MENU

Select General settings as detailed above

Press **ENTER** to access Set date/time settings

```
Set time
Set language
Set Photosensor
Calibration
Set display
Res. factory set
EC fan signal
```

TO SET THE DATE / TIME

The 'day' is initially selected and blinking

Press **UP** **DOWN** to change value

```
Set date/time
01.01.2017 00:00
```

Pressing **ENTER** will select the next entry: Month, Year and Time

```
Set date/time
01.01.2017 00:00
```

Pressing **SAVE EXIT** will save your entry and go back to the previous menu

SETTING THE LANGUAGE

From the 'General settings' menu (see page 6), press **DOWN** and scroll down to 'Set language'.

With 'Set language' flashing, press **ENTER** to access the language settings.

Use the **UP** and **DOWN** arrows to select your chosen language.

Press **SAVE EXIT** to save your information, and to go back to the previous sub menu.

LANGUAGE MENU

Select General settings as detailed on page 6

Press **DOWN** to scroll down to Set language

Press **ENTER** to access Language settings

```

Set time      | | | | |
Set language  | | | | |
Set photosensor | | | | |
Calibration   | | | | |
Set display   | | | | |
Res. factory set | | | | |
EC fan signal  | | | | |
  
```

Press **UP** **DOWN** to scroll to your chosen language

```

Set language  | | | | |
               | | | | | English
               | | | | | Deutsch
               | | | | | Français
               | | | | | Italiano
               | | | | | Español
               | | | | | Nederlands
  
```

Pressing **SAVE EXIT** will save your entry and go back to the previous menu

SETTING THE PHOTOSENSOR

This menu shows the current photosensor level at the top. You can adjust the value for the switch between day and night. The switch time is the delay before the controller changes mode from day to night, or night to day.

From the 'General settings' menu (see page 6), press **DOWN** and scroll down to 'Set photosensor'.

With 'Set photosensor' flashing, press **ENTER** to access the photosensor settings.

Press the **UP** or **DOWN** arrows to select 'Switch at:' or 'Switch time' and then press **ENTER** to select.

Press the **UP** or **DOWN** arrows to change the value and then press **SAVE EXIT** to save your information. Press again to go back to the previous sub menu.

NOTE: Setting the switch level too low may mean the controller never switches depending on the amount of residual light in the grow room.

PHOTOSENSOR MENU

Select General settings as detailed on page 6

Press **DOWN** to scroll down to Set photosensor

Press **ENTER** to access Photosensor settings

```

Set time      | | | | |
Set language  | | | | |
Set photosensor | | | | |
Calibration   | | | | |
Set display   | | | | |
Res. factory set | | | | |
EC fan signal  | | | | |
  
```

Press **UP** **DOWN** to make your selection

```

Photosensor    | | | | | 35%
Switch at:     | | | | | 70%
Switch time    | | | | | 1s
  
```

Press **UP** **DOWN** to change value

```

Switch at:     | | | | | 70%
  
```

Pressing **SAVE EXIT** twice will save your entry and go back to the previous menu

USING YOUR 13 AMP ENVIRO CONTROLLER V2

GENERAL SETTINGS MENU

CALIBRATING THE SENSORS

From the 'General settings' menu (see page 6), press **DOWN** and scroll down to 'Calibration'.

With 'Calibration' flashing, press **ENTER** to access the calibration settings.

The screen will display the current temperature on the top line.

'Temperat.' and the current offset will be flashing on the bottom line.

Press **ENTER** to adjust the offset using the **UP** and **DOWN** arrows.

When you press **SAVE EXIT** the current reading will be updated.

Use the **DOWN** arrow to repeat the process to change the humidity offset.

Press **SAVE EXIT** to save your information.

Press **SAVE EXIT** again to go back to the previous sub menu.



CALIBRATION MENU

Select General settings as detailed on page 6

Press  to scroll down to Calibration

Press  to access Calibration settings

```
Set time      |
Set language  |
Set photosensor |
Calibration   |
Set display   |
Res. factory set |
EC fan signal  |
```

Press   to scroll to your chosen setting

```
Calibration 25°C
Temperat.   | 0°
```

```
Calibration 55%
Humidity    | 0%
```

Pressing  will save your entry and go back to the previous menu

SETTING THE DISPLAY

From the 'General settings' menu (see page 6), press **DOWN** and scroll down to 'Set display'.

With 'Set display' flashing, press **ENTER** to access the display settings.

Use the **UP** and **DOWN** arrows to select your chosen setting of 'automatic', 'on' or 'off'.

Press **SAVE EXIT** to save your information, and to go back to the previous sub menu.

NOTE: The LED's will also follow the display.



DISPLAY MENU

Select General settings as detailed on page 6

Press  to scroll down to Set display

Press  to access display settings

```
Set time      |
Set language  |
Set photosensor |
Calibration   |
Set display   |
Res. factory set |
EC fan signal  |
```

Press   to scroll to your chosen setting

```
LED back light |
               | automatic
               | on
               | off
```

Pressing  will save your entry and go back to the previous menu

RESET TO FACTORY DEFAULTS

From the 'General settings' menu (see page 6), press **DOWN** and scroll down to 'Res. factory set'.

With 'Res. factory set' flashing, press **ENTER** to access the factory default settings.

Use the **UP** or **DOWN** arrows to select 'YES'.

Press **ENTER** to confirm your choice and the controller will begin to reset. The display will count up to 100% and once the reset is complete, all 5 LED's will briefly illuminate, and the display will change to the 'Home Screen'. Your controller has now been reset to factory defaults.



RESET TO FACTORY DEFAULT MENU

Select General settings as detailed on page 6

Press  to scroll down to Res. factory set

Press  to access Factory default settings

```
Set time      |
Set language  |
Set photosensor|
Calibration   |
Set display   |
Res. factory set|
EC fan signal  |
```

Press   to scroll to select YES

```
Reset controller|
NO?             |YES?
```

Press  to confirm your choice

```
Restore      |100%|
factory settings|
```

The display will count up to 100% and then display

```
Reset completed!|
Please wait      |
```

All 5 LED's will briefly illuminate, and the display will change to the Home Screen

SETTING THE EC SIGNAL

From the 'General settings' menu (see page 6), press **DOWN** and scroll down to 'EC fan signal'.

With 'EC fan signal' flashing, press **ENTER** to access the EC fan signal settings.

Use the **UP** and **DOWN** arrows to select the type of EC fan you are using.

Press **SAVE EXIT** to save your information, and to go back to the previous sub menu.

Make sure you get the correct signal type for your fan.

Hyperfan V2 should use the 0-10V revolution setting.

EC SIGNAL MENU

Select General settings as detailed on page 6

Press  to scroll down to EC fan signal

Press  to access EC signal settings

```
Set time      |
Set language  |
Set photosensor|
Calibration   |
Set display   |
Res. factory set|
EC fan signal  |
```

Press   to scroll to your chosen setting

```
Set EC Signal |
0-10V Revolution|
0-5V Hyper fan |
          PWM output
```

Pressing  will save your entry and go back to the previous menu

USING YOUR 13 AMP ENVIRO CONTROLLER V2

FAN SETTINGS MENU

This menu allows you to change your fan settings such as:

- Temperature
- Bandwidth
- Humidity settings
- Minimum & maximum fan speed
- Dump Override

TO ACCESS THE FAN SETTINGS MENU

From the 'Home Screen' press **ENTER** to access the sub menus.

'Set fan Speed' will be displayed and flashing.

Press **ENTER** to access the 'Fan settings' menu.

ACCESSING FAN SETTINGS

Start from the Home Screen

```
Room=23°C RH=60%
Set19°C 09:13
```

Press **ENTER** to access the first sub menu

```
Set fan Speed
Set exit 1
Set exit 2
General settings
```

Press **ENTER** to access the Fan settings menu

Press **▼** to scroll down the sub menus

```
Set temperature
Set humidity
Fan settings
Dump Override
```

SETTING THE FAN TEMPERATURE

From the 'Fan settings' menu (as detailed above), press **ENTER** and scroll down to 'Set temperature'.

With 'Set temperature' flashing, press **ENTER** to access the temperature settings.

Use the **UP** and **DOWN** arrows to select your chosen setting of 'Day', 'Night' or 'Bandwidth'.

With your chosen selection flashing press **ENTER** to highlight the corresponding value.

Use the **UP** and **DOWN** arrows to change the value.

Press **SAVE EXIT** to save your information, and press again to go back to the previous sub menu.

FAN TEMPERATURE BANDWIDTH

The bandwidth value is the difference in temperature from when the fans start up and when they are going at full speed.

The fans in the example to the right will start at 24°C and ramp up to full speed in 3°C. Therefore the fans will be at full speed at 27°C.

FAN TEMPERATURE MENU

Select Fan settings as detailed above

Press **ENTER** to access temperature settings

```
Set temperature
Set humidity
Fan settings
Dump Override
```

Press **▲▼** to make your selection

Press **ENTER** to highlight the corresponding value

```
Day 24.0°C
Night 20.0°C
Bandwidth 3.0°C
```

Press **▲▼** to change value

```
Day 24.0°C
/////////
/////////
```

Pressing **SAVE EXIT** will save your entry and go back to the previous menu

SETTING THE FAN HUMIDITY

From the 'Fan settings' menu (as detailed on page 10), press **DOWN** and scroll down to 'Set humidity'.

With 'Set humidity' flashing, press **ENTER** to access the humidity settings.

Use the **UP** and **DOWN** arrows to select your chosen setting of 'Day', 'Night' or 'Bandwidth'.

With your chosen selection flashing press **ENTER** to highlight the corresponding value.

Use the **UP** and **DOWN** arrows to change the value.

Press **SAVE EXIT** to save your information, and press again to go back to the previous sub menu.

FAN HUMIDITY BANDWIDTH

The bandwidth value is the difference in humidity from when the fans start up and when they are going at full speed. In this example, the fans will start to speed up to remove humidity 10% below set point and will run at maximum speed at set point.

These humidity settings will set the ventilation system to remove humidity by extracting it.

ALSO NOTE: Particularly at night time, temperatures can drop if the ventilation system is removing humidity and replacing it with cold air.

SETTING THE FAN SPEED

From the 'Fan settings' menu (as detailed on page 10), press **DOWN** and scroll down to 'Fan settings'.

With 'Fan settings' flashing, press **ENTER** to access the fan speed settings.

Use the **UP** and **DOWN** arrows to select your chosen setting of Minimum speed day & night, Maximum speed day & night or Negative pressure.

With your chosen selection flashing press **ENTER** to highlight the corresponding value.

Use the **UP** and **DOWN** arrows to change the value.

Press **SAVE EXIT** to save your information, and to go back to the previous sub menu.

Minimum speed Outtake:

Use this to have your ventilation system operating all the time. This will keep the outtake fan running and keep negative pressure in your room at all times, to stop odours escaping the room. Different values can be set for day and night.

Maximum speed Outtake:

To be used if noise is an issue. You can lower the maximum speed and therefore the maximum noise. Different values can be set for day and night.

Negative pressure Intake:

This will set your intake fan speed below your outtake fan. If you set it at -10% when the outtake fan is at 50% the intake fan will be at 45%. This is to maintain negative pressure in your grow room.

FAN HUMIDITY MENU

Select Fan settings as detailed on page 10

Press **DOWN** to scroll down to Set humidity

Press **ENTER** to access Humidity settings

```
Set temperature
Set humidity
Fan settings
Dump Override
```

Press **UP** **DOWN** to make your selection

Press **ENTER** to highlight the corresponding value

```
Day 60%
Night 50%
Bandwidth 10%
```

Press **UP** **DOWN** to change value

```
Day 70%
```

Pressing **SAVE EXIT** will save your entry and go back to the previous menu

FAN SPEED MENU

Select Fan settings as detailed on page 10

Press **DOWN** to scroll down to Fan settings

Press **ENTER** to access Fan speed settings

```
Set temperature
Set humidity
Fan settings
Dump Override
```

Press **UP** **DOWN** to make your selection

Press **ENTER** to highlight the corresponding value

```
Min. speed day
Outtake 20%
```

```
Min. speed night
Outtake 20%
```

```
Max. speed day
Outtake 70%
```

```
Max. speed night
Outtake 70%
```

```
Negativepressure
Intake -20%
```

Press **UP** **DOWN** to change value

```
Minimum speed
Outtake 20%
```

Pressing **SAVE EXIT** will save your entry and go back to the previous menu

USING YOUR 13 AMP ENVIRO CONTROLLER V2

FAN SETTINGS MENU

DUMP OVERRIDE FUNCTION

Allows you to programme your fans to dump the air out of your grow room. It takes your outlet fan up to the maximum set fan speed, and your inlet to the maximum fan speed, less the set negative pressure.

The timer works on a 24 hour clock and you can set 24 different times.

From the 'Fan settings' menu (as detailed on page 10), press **DOWN** and scroll down to 'Dump Override'.

With 'Dump Override' flashing, press **ENTER** to access the dump override settings.

Use the **UP** and **DOWN** arrows to select your chosen setting from 1 to 24.

With your chosen selection flashing press **ENTER** to highlight the corresponding **ON TIME** value.

Use the **UP** and **DOWN** arrows to change the value, and press **ENTER** to highlight the next value.

Once you have your chosen **ON TIME** settings, press **ENTER** to highlight the **OFF TIME** value. This shows hours : mins : secs and can be changed in the same way.

Press **SAVE EXIT** to save your information. Press **SAVE EXIT** again to go back to the previous sub menu.

DUMP OVERRIDE MENU

Select Fan settings as detailed on page 10

Press **DOWN** to scroll down to Dump Override

Press **ENTER** to access Dump Override settings

```
Set temperature
Set humidity
Set fan Speed
Dump Override
```

Press **UP** **DOWN** to make your selection from 1 to 23

Press **ENTER** to highlight the first value

```
Dump timer 1
0:00 00:00:00
```

ON TIME — hours : mins — OFF TIME — hours : mins : secs

Press **UP** **DOWN** to change value

```
Dump timer 1
0:00 00:00:00
```

Press **ENTER** to highlight the next value

Pressing **SAVE EXIT** will save your entry

Press **SAVE EXIT** again to go back to the previous menu

ENVIRO CONTROLLER V2 CONFLICTS

The Enviro Controller V2 fan controls should be carefully considered if you are using humidifiers or heaters in your environment.

Heaters

If you are using a heater on Exit 1 or Exit 2, make sure that the heater settings are below the fan temperature set points.

For example, if your day temperatures are set to 25°C and a heater setting is above 25°C, the fans will speed up and therefore remove the heat.

Humidifiers

If you are using a humidifier on Exit 1 or Exit 2, make sure that the humidity settings are below the fan humidity set points.

For example, if your day humidity is set to 60%, a humidifier setting above 60% will cause your fans to speed up to remove humidity.



CAUTION

Take care when using humidifiers or heaters in your environment.

EXIT 1 AND 2 SETTINGS

This menu allows you to change the settings of items connected to Exits 1 and 2 such as:

- A heater
- A humidifier
- A dehumidifier

TO ACCESS THE EXIT 1 OR EXIT 2 SETTINGS MENU

From the 'Home Screen' press **ENTER** to access the sub menus.

'Set fan speed' and 'Set exit 1' will be displayed. Press the **DOWN** arrow to scroll down to Set exit 1 or Set exit 2.

With 'Set exit 1 or Set exit 2' flashing, press **ENTER**

With 'Choose function' flashing, press **ENTER** to access the function that can be selected for the exit.

POWER ON / OFF SETTING

From the 'Choose function' menu (as detailed above), press **DOWN** and scroll down to 'Power'.

With 'Power' flashing, press **ENTER** to access the power settings.

Use the **UP** and **DOWN** arrows to select OFF or ON.

Press **SAVE EXIT** to save your information, and to go back to the previous sub menu.

ACCESSING EXIT 1 AND EXIT 2 SETTINGS

Start from the Home Screen

```
Room=23°C RH=60%
Set19°C 09:13
```

Press **ENTER** to access the first sub menu

Press **DOWN** to scroll down to Set exit 1 or Set exit 2

```
Set fan speed
Set exit 1
Set exit 2
General settings
```

Press **ENTER** to access Exit 1 or Exit 2

```
Choose function
```

Choose function is displayed

Press **ENTER** to access functions

Press **DOWN** to scroll down the sub menus

```
Power
Heat
Humidify
Dehumidify
Timer
```

EXIT 1 AND EXIT 2 POWER MENU

Select Set exit 1 or Set exit 2 settings as detailed above

Press **DOWN** to scroll down to Power

Press **ENTER** to access Power settings

```
Power
Heat
Humidify
Dehumidify
Timer
```

Press **UP** **DOWN** to make your selection

```
Ex1 off
Ex1 on
```

Pressing **SAVE EXIT** will save your entry and go back to the previous menu

USING YOUR 13 AMP ENVIRO CONTROLLER V2

EXIT 1 AND 2 SETTINGS

HEAT SETTING

You can set the desired temperature of your room when a heater is connected to Exit 1 or Exit 2. The controller will turn on the heater whenever it is below these values.

From the 'Set exit 1' or 'Set exit 2' settings menu (as detailed on page 13), press **DOWN** and scroll down to 'Heat'.

With 'Heat' flashing, press **ENTER** to access the heat settings.

Use the **UP** and **DOWN** arrows to select 'Heat day', 'Heatnight' or 'Bandwidth'.

With your chosen selection flashing press **ENTER** to highlight the corresponding value.

Use the **UP** and **DOWN** arrows to change the value.

Press **SAVE EXIT** to save your information, and to go back to the previous sub menu.

HEAT SETTING BANDWIDTH

The controller can be programmed to turn the heater on whenever it drops below your set room temperature.

The bandwidth is how many °C the temperature can drop below the set room temperature before the heater is turned back on. In the example to the right, during the day the heater will turn off at 24°C and turn back on at 22°C (bandwidth set to -2°C).

HUMIDIFY SETTING

With a humidifier connected to Exit 1 or Exit 2:

From the 'Set exit 1' or 'Set exit 2' settings menu (as detailed on page 13), press **DOWN** and scroll down to 'Humidify'.

With 'Humidify' flashing, press **ENTER** to access the humidifier settings.

Use the **UP** and **DOWN** arrows to select 'Humidify day', 'Humidi night' or 'Bandwidth'.

With your chosen selection flashing press **ENTER** to highlight the corresponding value.

Use the **UP** and **DOWN** arrows to change the value.

Press **SAVE EXIT** to save your information, and to go back to the previous sub menu.

HUMIDIFY SETTING BANDWIDTH

The controller can be programmed to turn the humidifier on whenever it drops below your set value.

The bandwidth is the % the humidity can drop below the set humidity value before the humidifier is turned back on. In the example to the right, during the day the humidifier will turn off at 60% and turn back on at 55% (bandwidth set to -5%).

EXIT 1 AND EXIT 2 HEAT MENU

Select Set exit 1 or Set exit 2 settings as detailed on page 13

Press **DOWN** to scroll down to Heat

Press **ENTER** to access Heat settings

```

Power  | | | | | | | | | |
Heat   | | | | | | | | | |
Humidify | | | | | | | | | |
Dehumidify | | | | | | | | | |
Timer  | | | | | | | | | |
    
```

Press **UP** **DOWN** to make your selection

Press **ENTER** to highlight the corresponding value

```

Exit1  | | | | | Temp
Heat day 24.0°C
Heatnight 20.0°C
Bandwidth -2°C
    
```

Press **UP** **DOWN** to change value

```

Heat Day 24.0°C
          ^^^^
    
```

Pressing **SAVE EXIT** will save your entry and go back to the previous menu

EXIT 1 AND EXIT 2 HUMIDIFY MENU

Select Set exit 1 or Set exit 2 settings as detailed on page 13

Press **DOWN** to scroll down to Humidify

Press **ENTER** to access Humidify settings

```

Power  | | | | | | | | | |
Heat   | | | | | | | | | |
Humidify | | | | | | | | | |
Dehumidify | | | | | | | | | |
Timer  | | | | | | | | | |
    
```

Press **UP** **DOWN** to make your selection

Press **ENTER** to highlight the corresponding value

```

Exit1  | | | | | Humidify
Humidify day 60%
Humidi night 55%
Bandwidth -5%
    
```

Press **UP** **DOWN** to change value

```

Humidify day 60%
          ^^^
    
```

Pressing **SAVE EXIT** will save your entry and go back to the previous menu

EXIT 1 AND 2 SETTINGS

DEHUMIDIFY SETTING

With a dehumidifier connected to Exit 1 or Exit 2:

From the 'Set exit 1' or 'Set exit 2' settings menu (as detailed on page 13), press **DOWN** and scroll down to 'Dehumidify'.

With 'Dehumidify' flashing, press **ENTER** to access the dehumidifier settings.

Use the **UP** and **DOWN** arrows to select 'Dehumidi day', 'Dehumi night' or 'Bandwidth'.

With your chosen selection flashing press **ENTER** to highlight the corresponding value.

Use the **UP** and **DOWN** arrows to change the value.

Press **SAVE EXIT** to save your information, and to go back to the previous sub menu.

DEHUMIDIFY SETTING BANDWIDTH

The controller can be programmed to turn the dehumidifier on whenever it drops below your set value.

The bandwidth is the % the humidity can drop below the set humidity value before the dehumidifier is turned off. In the example to the right, during the day the dehumidifier will turn on at 60% and turn back off at 50% (bandwidth set to 10%).

EXIT 1 AND EXIT 2 DEHUMIDIFY MENU

Select Set exit 1 or Set exit 2 settings as detailed on page 13

Press **DOWN** to scroll down to Dehumidify

Press **ENTER** to access Dehumidify settings

```

Power  | | | | | | | | | |
Heat   | | | | | | | | | |
Humidify | | | | | | | | | |
Dehumidify | | | | | | | | | |
Timer  | | | | | | | | | |
  
```

Press **UP** **DOWN** to make your selection

Press **ENTER** to highlight the corresponding value

```

Exit1 Dehumidify
Dehumidi day 60%
Dehumi night 50%
Bandwidth    10%
  
```

Press **UP** **DOWN** to change value

```

Dehumidi day>60%
              ^^^^
              ^^^^
  
```

Pressing **SAVE EXIT** will save your entry and go back to the previous menu

SET TIMER FUNCTION

Allows you to programme Exit 1 or Exit 2 to turn off at a specific time.

The timer works on a 24 hour clock and you can set 24 different times.

From the 'Set exit 1' or 'Set exit 2' settings menu (as detailed on page 13), press **DOWN** and scroll down to 'Timer'.

With 'Timer' flashing, press **ENTER** to access the timer settings.

Use the **UP** and **DOWN** arrows to select your chosen setting from '1' to '24'.

With your chosen selection flashing press **ENTER** to highlight the corresponding ON TIME value.

Use the **UP** and **DOWN** arrows to change the value.

Press **ENTER** to highlight the next value.

Press **SAVE EXIT** to save your information. Press **SAVE EXIT** again to go back to the previous sub menu.

EXIT 1 AND EXIT 2 DEHUMIDIFY MENU

Select Set exit 1 or Set exit 2 settings as detailed on page 13

Press **DOWN** to scroll down to Dehumidify

Press **ENTER** to access Dehumidify settings

```

Power  | | | | | | | | | |
Heat   | | | | | | | | | |
Humidify | | | | | | | | | |
Dehumidify | | | | | | | | | |
Timer  | | | | | | | | | |
  
```

Press **UP** **DOWN** to make your selection from 1 to 23

Press **ENTER** to highlight the first value

```

Exit1 timer 1
ON TIME 0:00 OFF TIME 00:00:00
hours : mins
  
```

Press **UP** **DOWN** to change value

```

Exit1 timer 1
0:00 00:00:00
  
```

Press **ENTER** to highlight the next value

Pressing **SAVE EXIT** will save your entry

Official Dealer

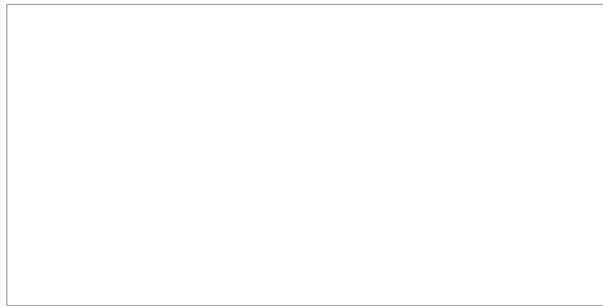

Distributed in the UK by:

Global Air Supplies UK Ltd

www.globalairsupplies.co.uk